

USER GUIDE

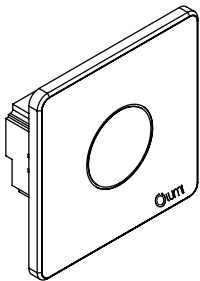

Dimmer - square shape

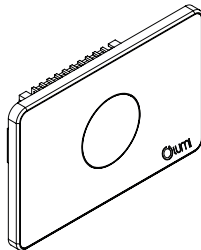

Dimmer - rectangle shape

DIMMER

MODEL: LM-S1D

Notice before Usage

Thank you for choosing Lumi Dimmer. You will receive the best supports from us.

Before usage, please read the user guide carefully to ensure that you totally understand all specifications of the device. The warranty does not cover issues from faulty installations and incorrect usage of the product

If having any questions, please feel free to contact us everytime.

Introduction

Lumi Dimmer can control On/Off and dimming the dimmer device. With a simple design compounded by tempered glass and capacitive touch, Lumi's devices will make your home become more elegant, modern and luxurious.

Also, based on Zigbee communication technology, the touch panel switch could be controlled remotely from everywhere providing the Internet available.

Once integrated into a smart home system, the device could be connected and worked with other devices such as motion sensor, door sensor, etc via a gateway.

Product Package

Device LM-S1D



Screws



User Guide



Technical Information

Power Supply	100 - 240V AC ~ 50/60Hz
Power consumption standby	<0,5W
Operational temperature	0°C - 50°C
Power rating	Non reactive load: 500W Led : 150W
Radio protocol	Zigbee
Dimensions (DxRxC)	95 x 95 x 31,5 mm (square) 121,5 x 80 x 31,5 mm (rectangle)

Safety Notes

- Do not use voltage different from the one stated in the device's specifications.
- Disconnect the device's power before installation or repair
- Do not place the device in high-temperature environment.
- Do not place the place in wet enviroment and near water source
- Do not disassemble the device if not necessary
- Do not clean the device with corrosive chemicals
- Safety instruction should be complied during the device usage.

Device's functions

Manual usage

Device LM-S1D with design compounded capacitive touch. User wants turn On/Off and dimming the dimmer device, just tap on the touch button (round shape) on switch. Led indication is bright Red - mean electric device turns on, Led indication is bright Blue - mean electric device turns off. Or user can touch on border of sensor area and rotate follow clockwise to increase brightness. Rotate follow counter clockwise to decrease brightness.

Advanced usage

Touch switch integrated with Zigbee protocol, when touch switch connected to Home Controller, it can be receive control command from App Lumi Life (on Smartphone, tablet...)

Moreover, device LM-S1D can work automatically according to rules, scenes, schedules was configured on App Lumi Life

WIRING INSTRUCTION AND USAGE

Wiring diagram

Wiring diagram

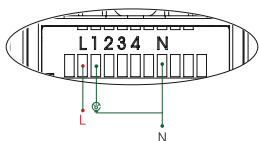

Wiring diagram for Dimming device

Wiring to load

Step 1: Using a screwdriver to remove the glass surface from the switch.

Note: There is a small hole on the body of the aluminum border to open glass easy.

Bước 2: Wire connection

- Line wire to L terminal
- Neutral wire to N terminal
- Line wires of dimmer to 1 terminal
- Neutral wire of load to N terminal.

Line wire
Load's wire
Neutral wire

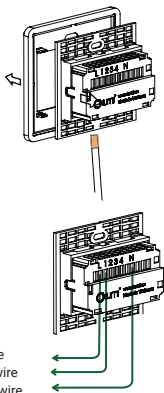

Installation

Step 1: Place the back part of a switch to the position of the junction on a wall.

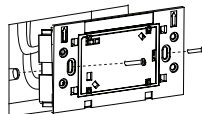

Step 2: Tighten two screws

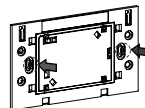

Step 3: Push glass on the back part to finish

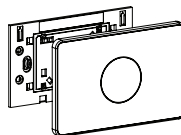

Usage

1. Turning On/Off and dimming device.

- Tap on touch panel to change state off electric devices. Led is bright Red mean On, Led is bright Blue Off.

- Touch on border of sensor area and rotate follow clockwise to increase brightness. Rotate follow counter clockwise to decrease brightness.



Increase brightness



Decrease brightness

2. Locking touch panels:

Quick click config button 10 times. On locking mode - Red Leds blink 5 times. On Unlocking mode - Blue Leds blink 5 times.

3. Change the light intensity of Led indication:

Press and hold the down config button for 5 seconds until luminous of Led indication changes (Has 2 modes: high & low intensity)

Using advanced function

Adding the device

User downloads App Lumi Life on App Store (iOS) or CH Play (Android). Log in App Lumi Life -> Select Setup -> Setup Devices -> Zigbee -> Adding Devices. After supplying power for device, the pink led blinks 2 times. Then there are 2 cases.

- If device was configured, pink led will blink 3 times (NOTE: In case of, the device was not displayed on App, user should try to reset device to return adding mode).

- If device was not configured, red led will blink 3 times, after that device will find Zigbee network to join. When device joins into Zigbee network successfully, pink led will blink 3 times.

User can configure rules/scenes/schedules for devices on App Lumi Life.

Reset device

For reset and get device get out the Zigbee network, user click config button 5 times. If device still enable on Zigbee network, after resetting process pink led will blink 2 times to inform resetting process was successfully. Then pink Led will blink 2 more times and red led will blink 3 times to inform device was on adding mode

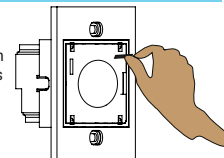

Warranty

24 months of warranty for all Lumi's products based on time written on stamp.

Warranty will not be accepted in some cases.

- Damage caused by disaster, fire, lightning, unstable power supply.
- Damage caused by Usage in wrong way different from the user guide.
- Damage or scratch caused by strong collision.
- Damage caused by installation in a wet environment.
- Damages caused by faulty electrical installation by the customer, including the use of incorrect fuses
- Just being warranted in the warranty time.